

Floor Plan

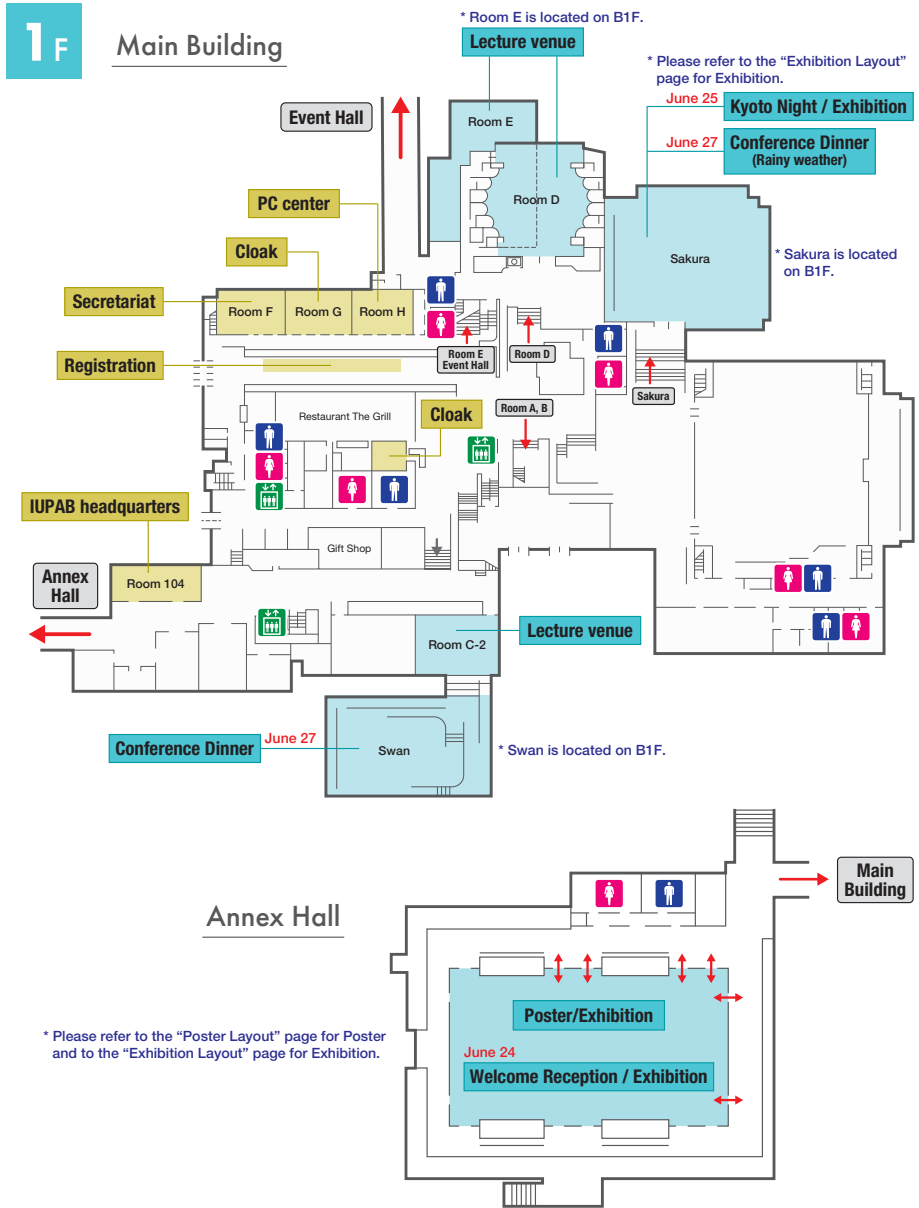

2 F Main Building

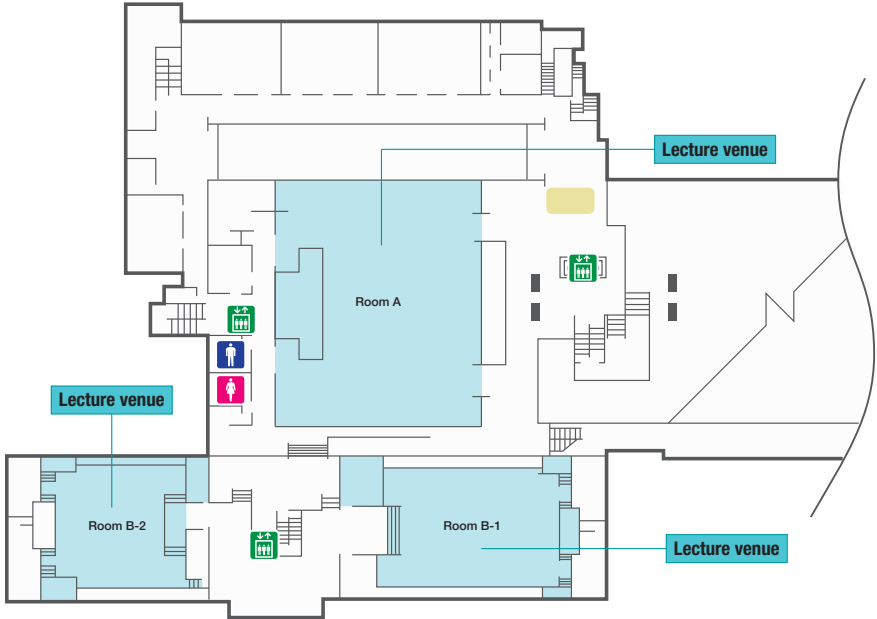

5 F Main Building

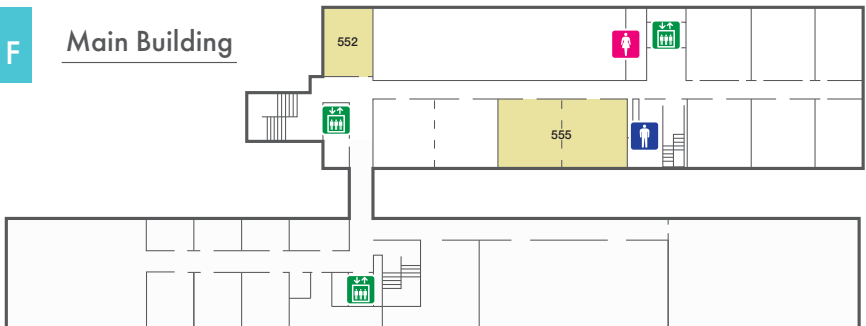

Poster Layout

June 25 [TUE]

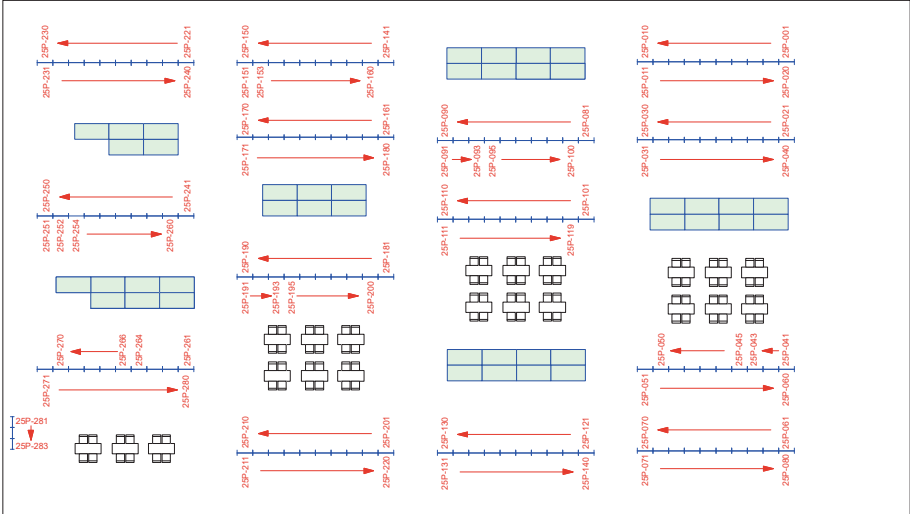

June 26 [WED]

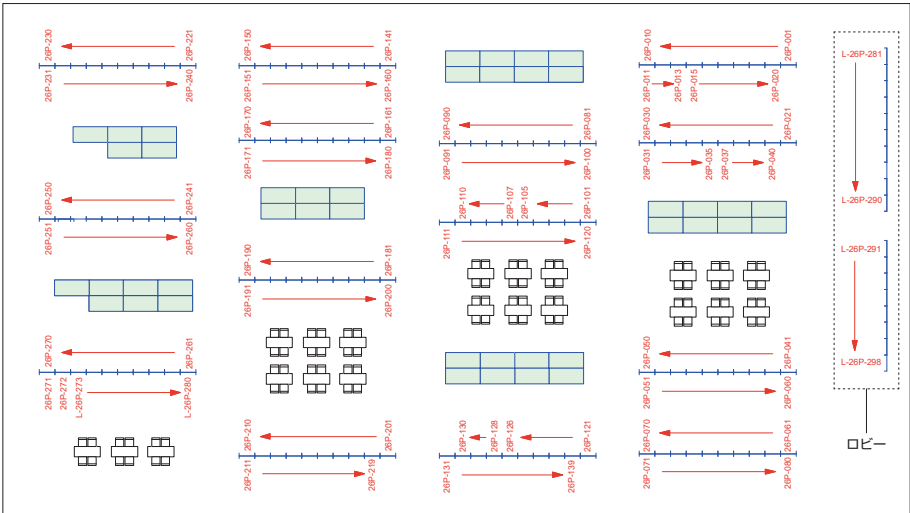

June 27 [THU]

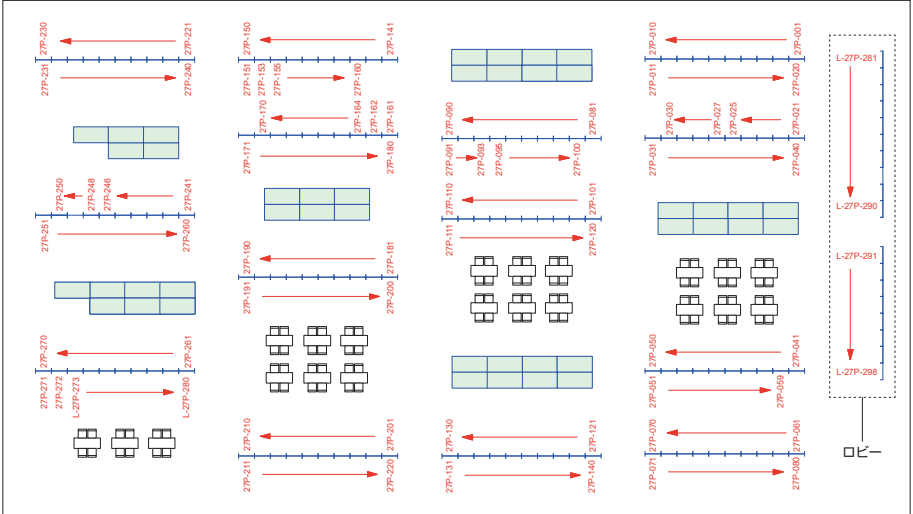

June 28 [FRI]

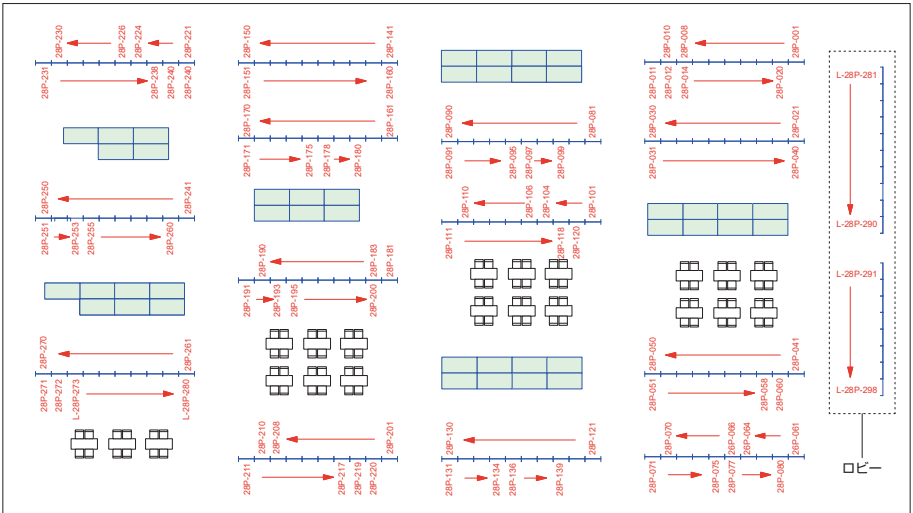

Exhibition Layout

Annex Hall (June 25 [TUE] – 28 [FRI])

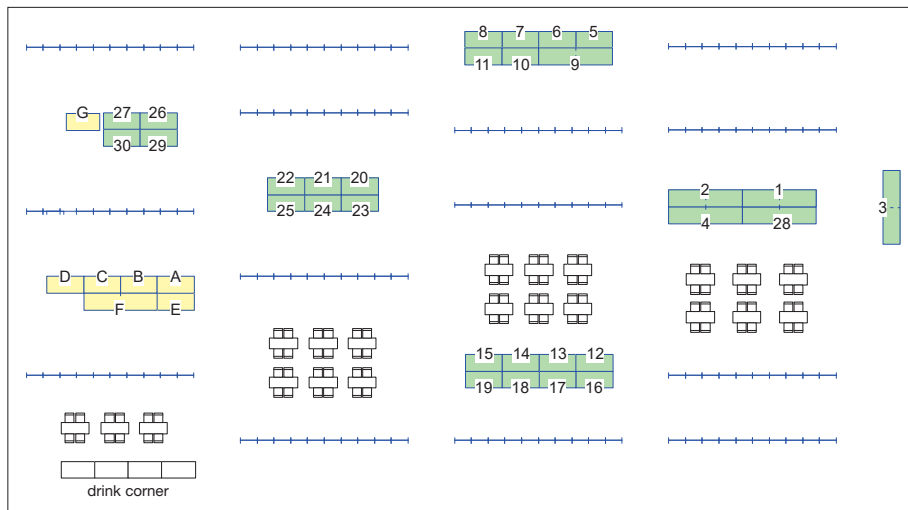

| No. | Exhibitor | No. | Exhibitor |
|-----|----------------------------------|-----|---|
| 1 | BLAST Inc. | 21 | Research Institute of Biomolecule Metrology Co., Ltd. |
| 2 | Oxford Instruments K.K. | 22 | Bruker Japan K.K. |
| 3 | Nikon Solutions | 23 | Yokogawa Electric Corporation |
| 4 | Evident Corporation | 24 | SIGMAKOKI CO., LTD. |
| 5 | On-chip Biotechnologies Co., Ltd | 25 | Japan Laser Corporation |
| 6 | TOKYO OHKA KOGYO CO., LTD. | 26 | FUJIFILM Wako Pure Chemical Corporation |
| 7 | NanoAndMore Japan K.K. | 27 | Yamato Scientific Co., Ltd. |
| 8 | HORIBA, Ltd. | 28 | Quantum Design Japan |
| 9 | ORIENTAL GIKEN INC. | 29 | Pinpoint Photonics, Inc. |
| 10 | Chroma Technology Japan | 30 | CellFree Sciences Co., Ltd |
| 11 | Nanon Technologies Japan K.K. | A | Nakatani Foundation for Advancement of Measuring Technologies in Biomedical Engineering |
| 12 | JEOL Ltd. | B | Japan Synchrotron Radiation Research Institute (JASRI) |
| 13 | Refeyn | C | Worldwide Protein Data Bank |
| 14 | Carl Zeiss Co. Ltd. | D | The DNA Bank, RIKEN BioResource Research Center (RIKEN BRC DNABank) |
| 15 | Avanti Polar Lipids | E | Japan Agency for Medical Research and Development |
| 16 | TAITEC CORPORATION | F | The Biophysical Society of Japan |
| 17 | Thorlabs Japan Inc. | G | Clinica Publishers, LLC |
| 18 | Kiko Tech Co., Ltd. | | |
| 19 | Tokai Hit Co., Ltd. | | |
| 20 | HAMAMATSU PHOTONICS K.K. | | |